

L3-WK-D

Wall Switch, Decora

Wall switch has a top and bottom momentary button with a gentle tactile feel when pressed. Use with L2-DM or L2-SW to control zones of lights. These provide an intuitive user experience with familiar decora shape and operation. For 3-way and multi-way switching, simply add more L3-WK-D to the Cat5/6 wire. Two RJ45 jacks on the back allow switches to be connected in series, or connect a splitter/combiner to join two wires into a single PDM port. The L3-WK-D has an orientation and should always be installed with the Top button at the top. Lights can be powered passing through switches but it is recommended to place switches after lights as the wires leave the PDM ports. Refer to the system overview to understand how LumenCache inputs and outputs apply to wiring design. Four colors are available. Custom colors are available for special order. Use any standard Decora-style cover plates.

ELECTRICAL

- Voltage 5VDC
- Power 0.0W (passive)
- Input module Use L2-DM or L2-SW at the PDM Socket

PHYSICAL/ENVIRONMENTAL

- Cover plate shape Decora style and shape
- Construction Metal carrier, plastic buttons
- Height 106 mm
- Width 44.3 mm
- Depth 16.19 mm
- Operating temperature 0°F to +122°F (-17°C to +50°C)
- Operating humidity 5% to 95% Non-condensing
- Safety certifications FCC, CE
- Rating Damp Rated

WARRANTY

- Duration 5 Years

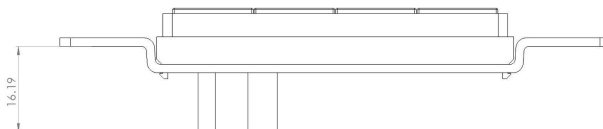
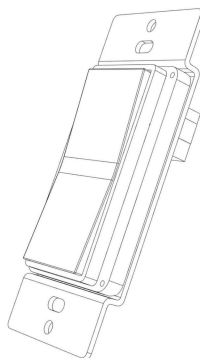

ORDERING INSTRUCTIONS:

| PART ID | MODEL | DESCRIPTION |
|------------|------------|----------------------------|
| 22010110.0 | L3-WK-D-WH | Wall Switch, Decora, White |
| 22010111.0 | L3-WK-D-BK | Wall Switch, Decora, Black |
| 22010112.0 | L3-WK-D-BR | Wall Switch, Decora, Brown |
| 22010113.0 | L3-WK-D-GY | Wall Switch, Decora, Gray |