

# L3-TP-1111-D

## Wall TouchPad, 1-4 button, Decora

Wall touchpad has 4 gently backlit touch zones with a positive indication of button presses. Use with an L2-DM to control zones of lights or lighting scenes. For multiple keypad locations, simply add more L3-TP4-D to the Cat5/6 wire. Each unit has a selector switch to choose between buttons 1-4 and 5-8, allowing up to 8 button actions to be sensed by the L2-DM at the PDM. Two RJ45 jacks on the back allow touchpads to be connected in series, or connect a splitter/combiner to join two wires into a single PDM port. The L3-TP4-D can be installed in any orientation. Lights can be powered passing through touchpads but it is recommended to place touchpads and switches after lights as the wires leave the PDM ports. Refer to the system overview to understand how LumenCache inputs and outputs apply to wiring design. Two rim colors are available. Custom rim colors are available for special order. Use any standard Decora-style cover plates. The tempered glass touch face can have custom artwork and is quickly field replaceable.

### ELECTRICAL

Voltage 5VDC, 12VDC from L2-APR at the PDM  
 Power 0.1W  
 Input Module Use L2-DM at the PDM Socket

### PHYSICAL/ENVIRONMENTAL

Cover plate shape Decora style and shape  
 Construction Metal carrier, tempered glass face  
 Height 106 mm  
 Width 44.3 mm  
 Depth 16.19 mm  
 Operating temperature 32°F to +122°F (0°C to +50°C)  
 Operating Humidity 5% to 95% Non-condensing  
 Safety Certifications FCC, CE  
 Rating Dry Rated

### WARRANTY

Duration 5 Years

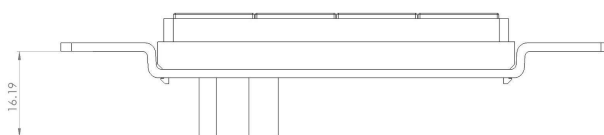

### ORDERING INSTRUCTIONS:

PART ID	MODEL	DESCRIPTION
23040110.0	L3-TP-1111-D-WH	Wall TouchPad, 4 button, 1111 layout, Decora, White
23040111.0	L3-TP-1111-D-BK	Wall TouchPad, 4 button, 1111 layout, Decora, Black